

A66 Northern Trans-Pennine Project

Scheme 06: Appleby to Brough

TR010062

5.24 Tree Preservation Order Trees Location Plans (Rev 2)

APFP Regulations 5(2)(I)

Planning Act 2008

**Infrastructure Planning (Applications: Prescribed Forms and
Procedure) Regulations 2009**

Deadline 7

09 May 2023

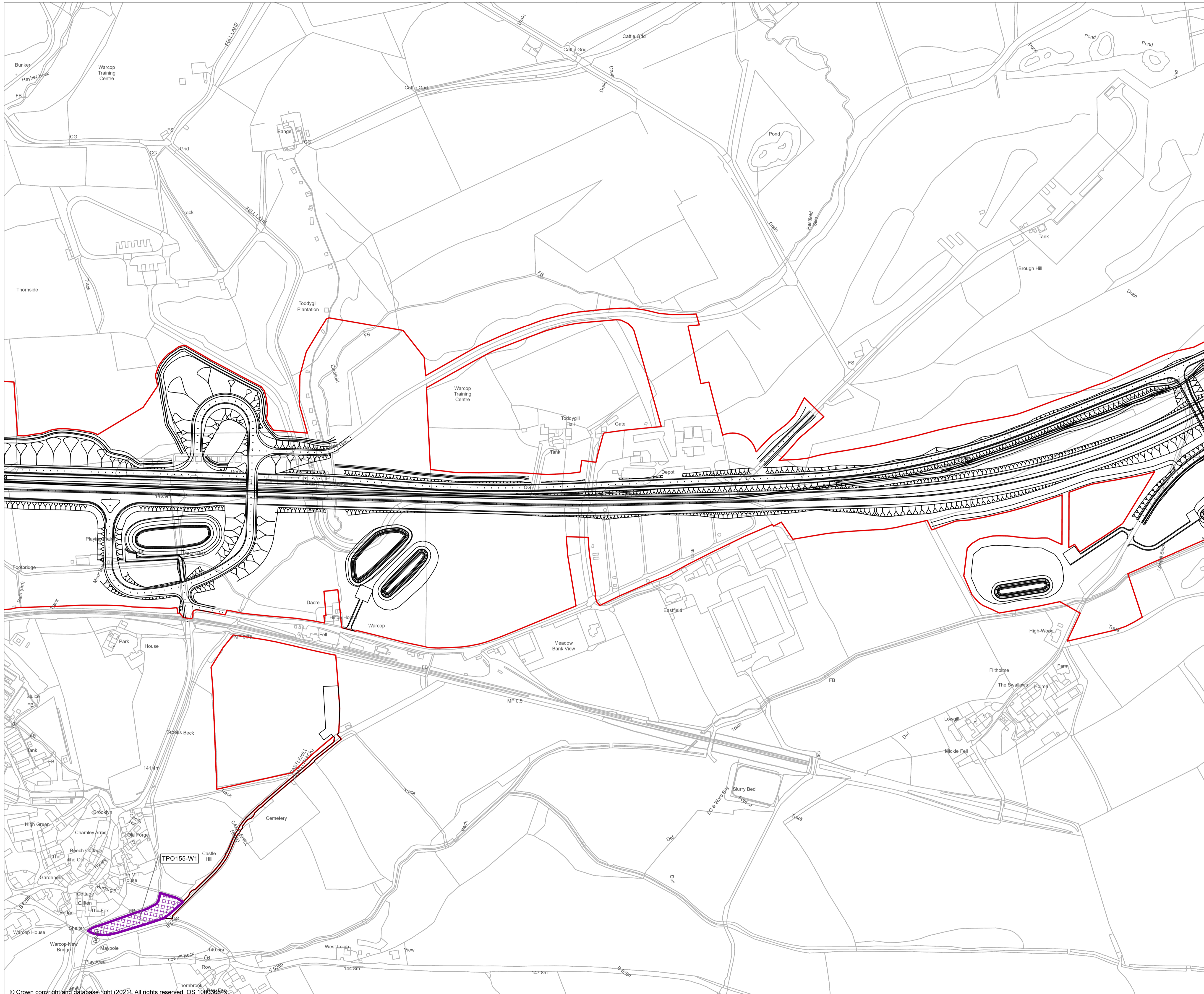

- NOTES**
1. ALL DIMENSIONS ARE IN METRES UNLESS STATED OTHERWISE.
 2. THESE PLANS SHOULD BE READ IN CONJUNCTION WITH OTHER PLANS AND DOCUMENTS IN THE DEVELOPMENT CONSENT ORDER APPLICATION.
 3. TREE PRESERVATION ORDERS (TPO) ARE MADE UNDER THE TOWN AND COUNTRY PLANNING (TREE PRESERVATION) (ENGLAND) REGULATIONS 2012.

TREE PRESERVATION ORDERS WITHIN THE DCO BOUNDARY

| TPO NUMBER | DESCRIPTION |
|------------|--|
| TPO155-W1 | NARROW WOODLAND BETWEEN CROOKS BECK AND CASTLEHILL ROAD TO THE EAST OF THE WAR MEMORIAL IN WARCOPI |

- KEY**
- ROUTE ALIGNMENT
 - EXISTING A66
 - ORDER LIMITS
 - TREE PRESERVATION ORDER WITHIN THE ORDER LIMITS
 - TREE PRESERVATION ORDER (TPO) / WOODLAND
 - COUNTY BOUNDARY

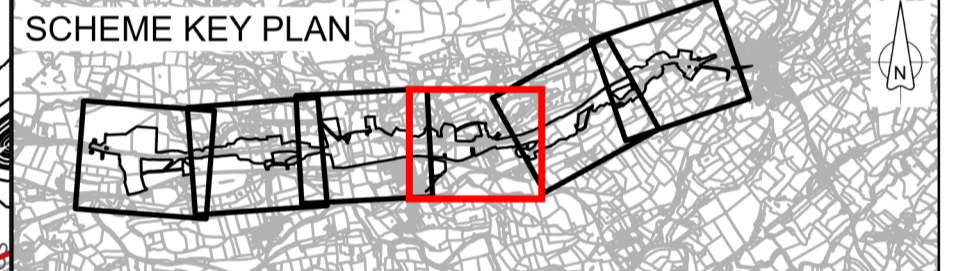
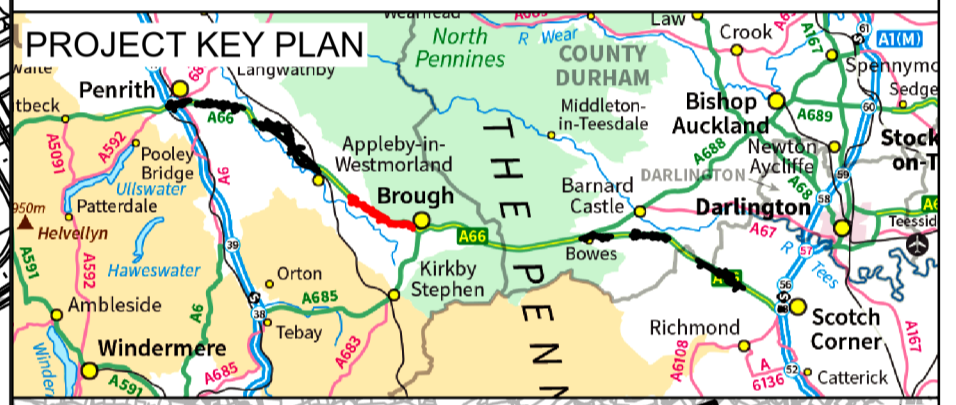

| C02 | DC-21 & DC-23 Changes to design and Order limits | | | | |
|------------------|--|----------|----------|----------|------------|
| | PKEL | CESL | LPAG | LWAL | SBAG |
| | 20/04/23 | 20/04/23 | 21/04/23 | 21/04/23 | 21/04/23 |
| Revision details | | | | | |
| Revision | Created | Checked | Reviewed | Approved | Authorised |
| | dd/mm/yy | dd/mm/yy | dd/mm/yy | dd/mm/yy | dd/mm/yy |

Purpose
DCO APPLICATION

PINS Reference Number
TR010062/APP/5.24

Client
3 Piccadilly Place
Manchester
M1 3BN



Project Name / Scheme Name
**A66 Northern Trans-Pennine Project
Scheme 06
Appley to Brough**

Drawing Title
**Tree Preservation Order
Trees Location Plan
Regulation 5(2)(l)
Sheet 1 of 1**

| Project Ref. No. | Stage | Scale | Sheet |
|------------------|-------|---------------|-------|
| --- | PCF 3 | 1:2500 | @ A1 |
| | | Dimension : M | |

| Drawing Number | | | |
|----------------|------------|--------|---------------|
| Project | Originator | Volume | Sheet |
| HE565627 | AMY | HAC | - |
| S06 | | DR | CH - 000111 |
| Location | | Type | Role Number |

| Suitability | Suitability Description | Revision |
|-------------|-------------------------|----------|
| S4 | FIT FOR STAGE APPROVAL | C02 |